

DO NOT SCALE - IF IN DOUBT ASK

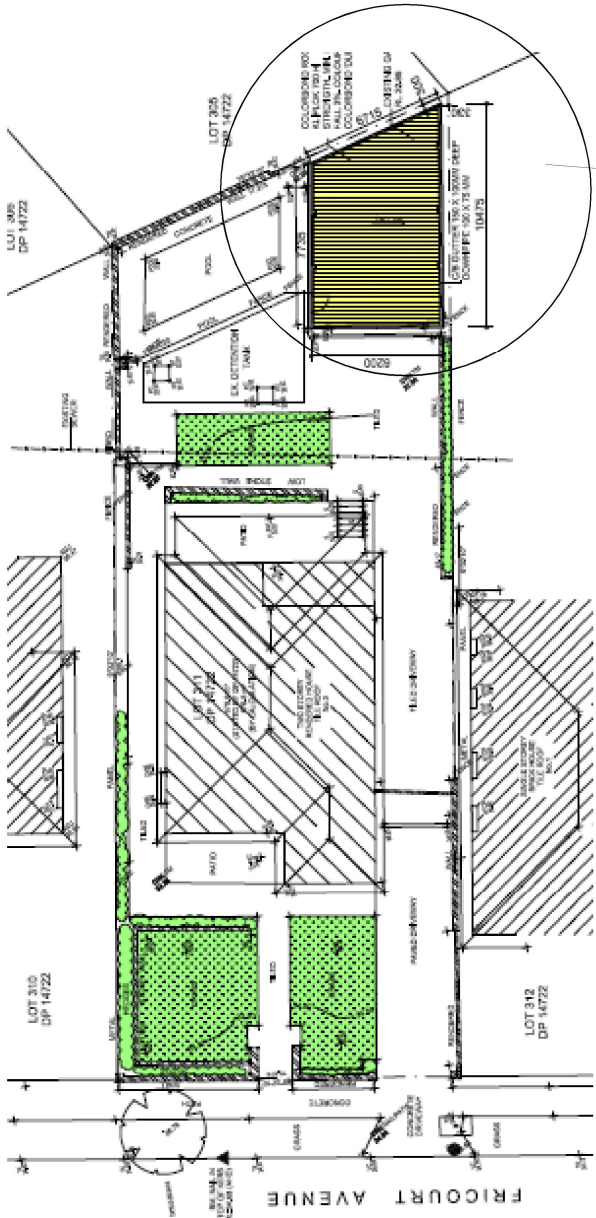

SITE PLAN

GENERAL

- G1** All materials, workmanship and other items be supplied for the execution of these works shall be in accordance with this document, these drawings, future drawings, schedules and verbal and/or written instructions which may be given during the progress of the work.
- G2** These drawings (This drawing) are to be read in conjunction with other consultants drawings and specifications.
- G3** All workmanship and materials are to be in accordance with requirements of the relevant Australian Standard Codes, Building Code of Australia and regulations as specified by local Authorities and utility providers.
- G4** Dimensions shall not be obtained by scaling the drawings and all dimensions to be verified by the builder prior to commencement of work.
- G5** If any ambiguity exists on these drawings the Engineer shall be contacted immediately prior to any work been carried out, to clarify all discrepancies before proceeding with any work.
- G6** Any works shown or indicated on the drawings but not in the specification or vice versa, and any item that is not shown in either plan or specification but which is obviously necessary as part of proper construction and/or finish shall be considered as shown or specified and it is to be done as part of the Contract.

MAINTENANCE

M1 Gutters shall be cleaned at least once a year.

SAFETY IN DESIGN

There is no inherent risks with building, installing, maintaining, operating and demolishing this stormwater system.
The design is typical and similar to residential stormwater installations.
We have not identified any unique risks BUT the constructors, owners and operators must adopt proper safety procedures and activities.

STORMWATER

- W1** All workmanship and materials to be in accordance with AS 3500 and other relevant SA Codes.
- W2** All work shall comply to the requirements of the appropriate authorities (Sydney Water and Local Council).
- W3** The installation of pipes and accessories shall not effect the structural integrity of the structure. Ensure excavation for pipes do not affect the long-term stability of the footings.
- W4** Stormwater shall be provided to the Local council requirements. All pipes used shall be of a minimum diameter of 100mm. Provide inspection points at every point of change of direction or a maximum distance of 15 m.

- G9** The Builder shall use all necessary safety equipment and apply safe practices.
- G10** The Builder shall verify all dimensions and levels prior to commencement of the works.
- G11** The Builder shall certify the quality of all the goods, materials and services to be provided.
- G12** All material, workmanship, fabrication, construction shall comply with the National Construction Code (Australian Building Code).
- G13** All measurements are in mm Unless Noted Otherwise

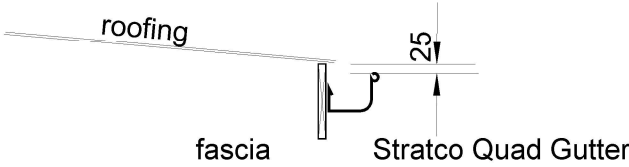

TYPICAL EAVES GUTTER ARRANGEMENT

Not To Scale

Gutters and downpipe shall be colourbond finish to match existing

Connect downpipe to existing stormwater system. Existing stormwater system shall be checked and if required repair and clean it.

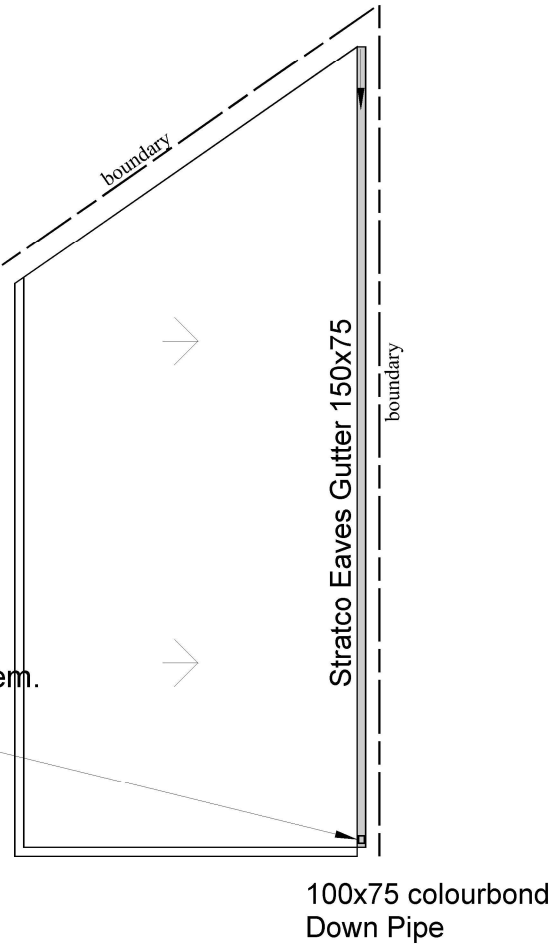

EXISTING GARAGE ROOF PLAN

1 : 100

Design parameters

All eave gutters shall be install with a slope of 1 : 500 or steeper
All gutters shall be fitted with leaf covers.
All eave gutters are designed for a 1 : 20 storm - 199 mm/hr

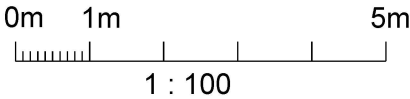

NOTATION



DENOTES DIRECTION OF GUTTER & PIPE FLOW AND SLOPE

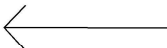

DENOTES DIRECTION OF SURFACE SLOPE

PAZ ENGINEERING		ENGINEERING DETAILS - STORMWATER DRAINAGE PLAN FOR PROPOSED GARAGE ROOF REPLACEMENT	
B. Pazpinis BE, MEng, MIEAusst., CPEng.		AT 3 FRICOURT AVENUE, EARLWOOD	
Phone: (02) 9344 5695 0439 645 932	Date : 14/04/22 pazeng@tpg.com.au	SCALE 1:100 U.N.O.	220420 AMEND.